

 935-PD36W

 935-PD36

## CONTENT:

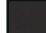
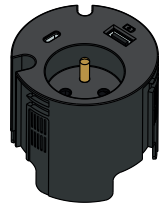

x1



x1



x1

### 1 DRILL



### 2 INSERT

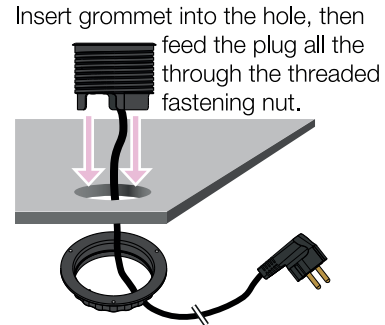

### 3

#### TURN CLOCKWISE & PLUG IN

Turn the fastening nut as far up the thread as possible. Make sure that it has been thoroughly tightened. Plug the French plug into a wall socket or powerstrip of your choice. Lastly, connect the USB-C cable to the intended device.

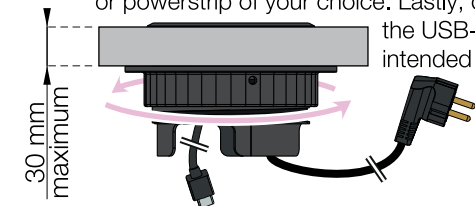

**Note!** The fastening nut has 3 holes for fixing with wood screws.

### A ADJUSTING HEIGHT

Connect plug to Powerdot to begin releasing the inner part of the grommet.

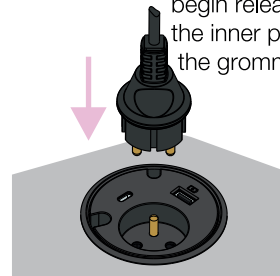

### B RELEASE INNER PART

Rotate plug counter-clockwise to release the inner part.

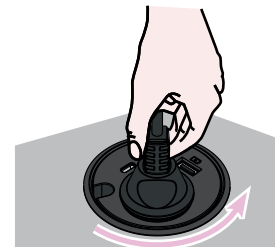

### C

#### ADJUSTING HEIGHT

The inner part should now be loose. Adjust to desired level - see box: ADJUST LEVELS

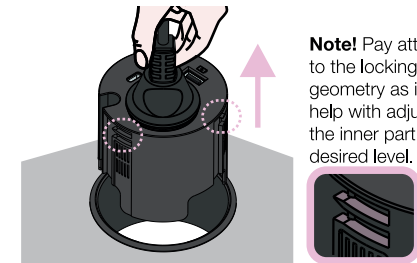

### ! ADJUST LEVELS

Level 2 must be used when combined with the decorative accessories.

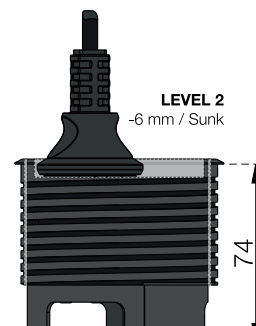
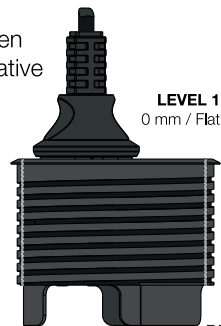
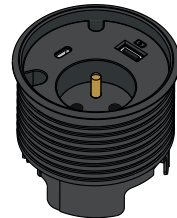

### D LOCKING POSITION

Rotate clockwise.

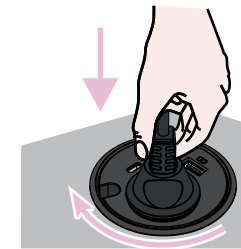

### E LOCKING POSITION

Rotate clockwise.

