

Powerdot

 935-PD36W

 935-PD36

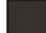

CONTENT:

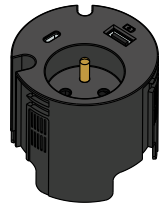

x1



x1



x1

1 DRILL



2 INSERT

Insert grommet into the hole, then feed the plug all the way through the threaded fastening nut.

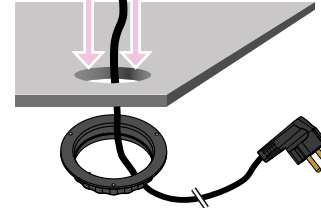

3 TURN CLOCKWISE & PLUG IN

Turn the fastening nut as far up the thread as possible. Make sure that it has been thoroughly tightened. Plug the French plug into a wall socket or powerstrip of your choice. Lastly, connect the USB-C cable to intended device.

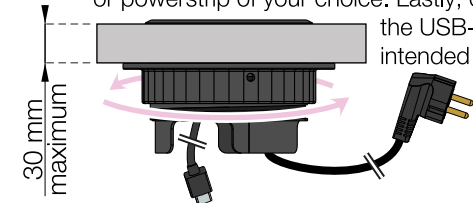

Note! The fastening nut has 3 holes for fixing with wood screws.

A ADJUSTING HEIGHT

Connect plug to Powerdot to begin releasing the inner part of the grommet.

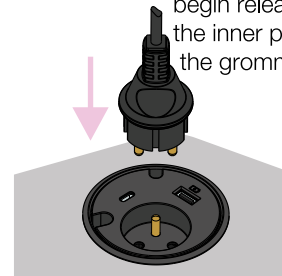

B RELEASE INNER PART

Rotate plug counter-clockwise to release the inner part.

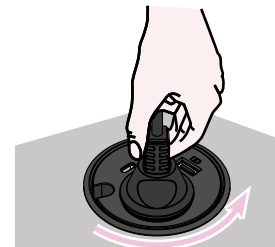

C ADJUSTING HEIGHT

The inner part should now be loose. Adjust to desired level - see box: ADJUST LEVELS

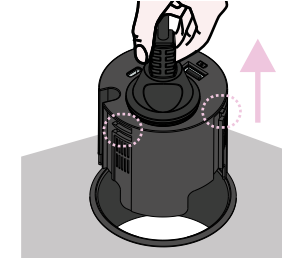

Note! Pay attention to the locking geometry as it will help with adjusting the inner part to the desired level.



! ADJUST LEVELS

Level 2 must be used when combined with the decorative accessories.

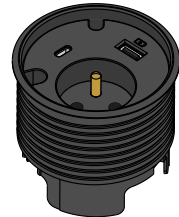

LEVEL 1
0 mm / Flat

68

LEVEL 2
-6 mm / Sunk

74

D LOCKING POSITION

Rotate clockwise.

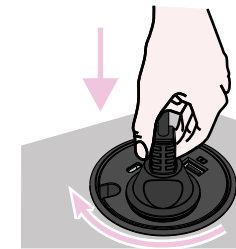

E LOCKING POSITION

Rotate clockwise.

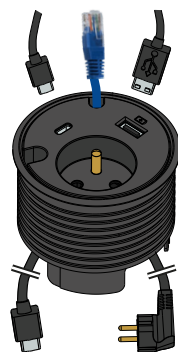
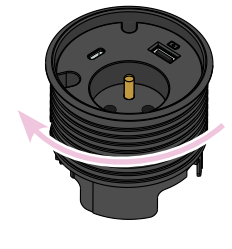

- 1 USB Charger
QC2.0 (Type-A)

- 1 French socket
/w 1500 mm cable

- 1 USB Port
(Type-C Female)
/w 450 mm cable

- 2 feed-throughs
(Ø7, Ø9,5 mm)